

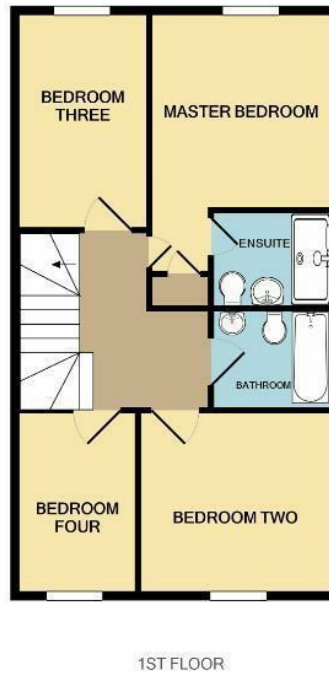

## ||| Loachbrook Farm Way, Congleton, Cheshire, CW12 4BF

£1,500 PCM

- Semi-Detached Four Bedroom Home
- Ground Floor Cloakroom
- Good Size Plot With Gardens Front & Rear
- Available Immediately With a Monthly Rental £1,350
- Modern Kitchen with Integral Appliances
- Master Bedroom With En-Suite Shower Room
- Single Garage & Private Driveway Providing Ample Off Road Parking
- Spacious Open Plan Living & Defined Dining Area
- Modern Family Bathroom
- EPC Rating C

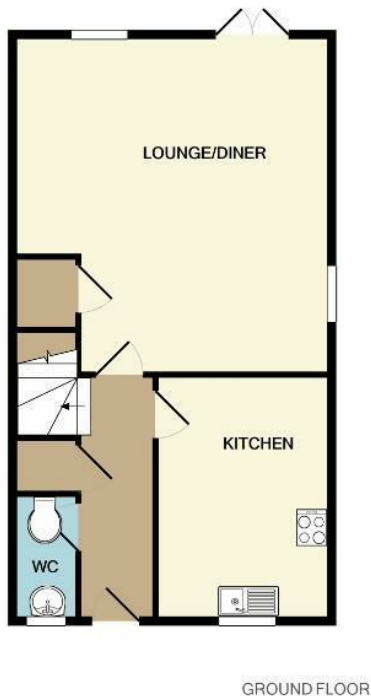

Whilst every attempt has been made to ensure the accuracy of the floor plan contained here, measurements of doors, windows, rooms and any other items are approximate and no responsibility is taken for any error, omission, or mis-statement. This plan is for illustrative purposes only and should be used as such by any prospective purchaser. The services, systems and appliances shown have not been tested and no guarantee as to their operability or efficiency can be given.  
Made with Metropix ©2019

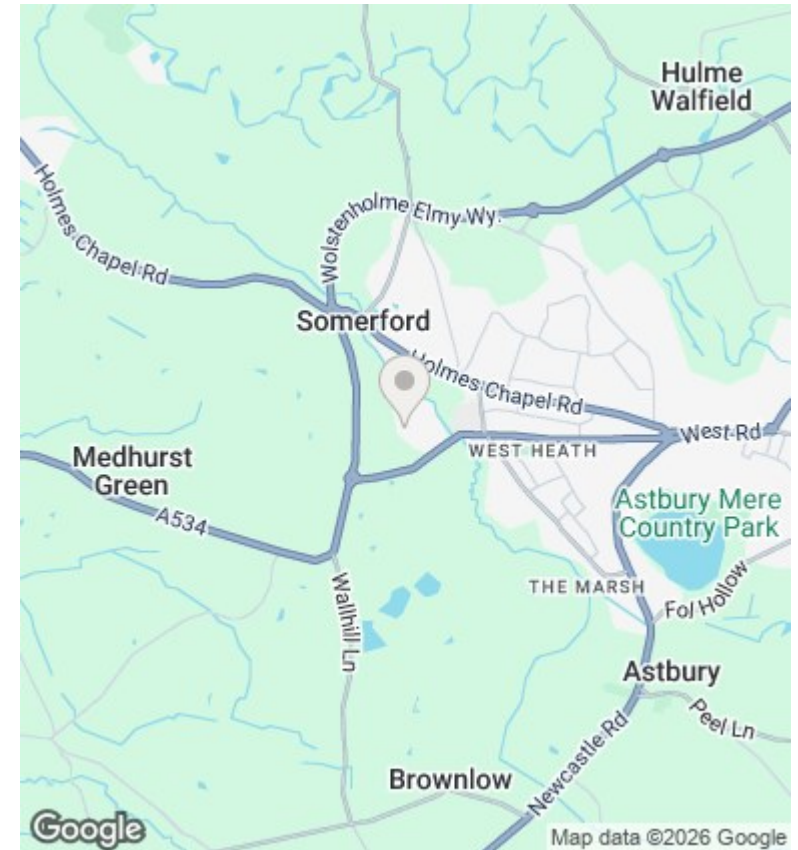

## Directions

Leave Congleton on the A534 Sandbach Road, continue along this road passing through West Heath, at the main traffic lights at the cross road continue straight across, the new Bovis Homes development can be found on the right. Turn right into Field View Road, follow the road around to the left then keep left and continue along which then becomes Loachbrook Farm Way, the property can be found on the right.

## Viewings

Viewings by arrangement only. Call 01625 430044 to make an appointment.

## Council Tax Band

D

## EPC Rating:

Energy Efficiency Rating		
	Current	Potential
<i>Very energy efficient - lower running costs</i>		
(92 plus) <b>A</b>		
(81-91) <b>B</b>		
(69-80) <b>C</b>		
(55-68) <b>D</b>		
(39-54) <b>E</b>		
(21-38) <b>F</b>		
(1-20) <b>G</b>		
<i>Not energy efficient - higher running costs</i>		
<b>England &amp; Wales</b>	EU Directive 2002/91/EC	